

ULTRA-SENSE[®]

Sensor Faucets with Position-Sensitive Detection



Symmons[®]

ULTRA-SMART. ULTRA-SOPHISTICATED. ULTRA-RELIABLE. ULTRA-SENSE®

It makes sense to select the sensor faucet with technology that's more advanced and more reliable than any faucets you've seen before. Symmons' new Ultra-Sense isn't tied to old solutions or limited technology. Instead, it combines our unique Position Sensitive Detection (PSD) technology to create a faucet that just makes better sense—and provides the features you're looking for:

- PSD sensors are unaffected by inconsistent lighting environments, varying surface colors or textures and splashes—resulting in the most reliable performance available.
- Model can be installed for preset or user-adjustable temperatures offering flexibility for your specific application (model S-6080 only).
- 1.5 gpm vandal-resistant aerator conserves water and energy.
- Hands-free operation facilitates better hygiene.
- Solid brass construction minimizes vandalism and provides years of trouble-free performance.
- Battery-powered model features energy-efficient, long-life 6V lithium battery. (lasts approximately 4 years at 210 cycles per day)
- Watertight seals protect the sensors and control electronics while providing convenient, above-the-counter access.
- Handle limit stop provides additional safety in public restrooms.
- Transformer power options available for single plug-in or gang installations (model S-6110 only).
- Installation options include 4" and 8" center set or single hole mounting.

Why ULTRA-SENSE'S

PSD Technology Makes Sense.

Ultra-Sense's PSD technology doesn't have the same color, lighting and distance limitations of traditional infrared faucets. That's because Ultra-Sense opto-electronics perform an "active triangulation measurement" of an object's distance from the faucet—instead of measuring its infrared temperature.

With PSD, a sender LED projects an infrared beam through a sender lens, which focuses on an approaching object. The spot of light that reflects back from the object is focused through a receiver

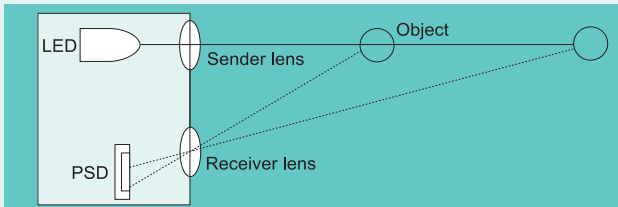

objects are placed approximately one foot (300 mm) away from an Ultra-Sense faucet with PSD, they will be measured to within 5% of their distance, as opposed to less than 50% with conventional infrared faucets.



lens to a location on the PSD sensor. This location is proportional to the object's distance from the sensor. When the sensor detects an object within its set limit, water flow is triggered. When the object moves beyond the limit, water flow stops.

As a result of Position Sensitive Detection (PSD), an object's color or surface quality is no longer a factor in its detection. In fact, when different colored

ULTRA-SENSE[®] Battery-Powered Faucets with PSD

S-6080-G With grid drain assembly **S-6080** Faucet Only

ULTRA-SENSE battery-powered, sensor-activated lavatory faucet with infrared Position Sensitive Detection (PSD) system. Faucet features 4" center deck plate and temperature limit stop to adjust outlet temperature, 1.5 gpm (5.7 L/min) low profile, vandal-resistant aerator. 10 second factory-set cycle time with automatic shut-off feature, 6-volt lithium battery power pack, in-line check/strainers. Electronic components and battery are sealed and housed above deck in a cast brass body for maximum vandal resistance.

Every S-6080 faucet comes equipped to be installed in one of three possible supply configurations, providing optimum flexibility for new construction as well as remodel or renovation projects.

Faucet can be installed in one of three possible supply configurations:

1. Hot and cold supply with lever handle temperature adjustment (factory standard)
2. Hot and cold supply with pre-set tempered water (field adjusted)
3. Single supply for cold or premixed tempered water (field adjusted)

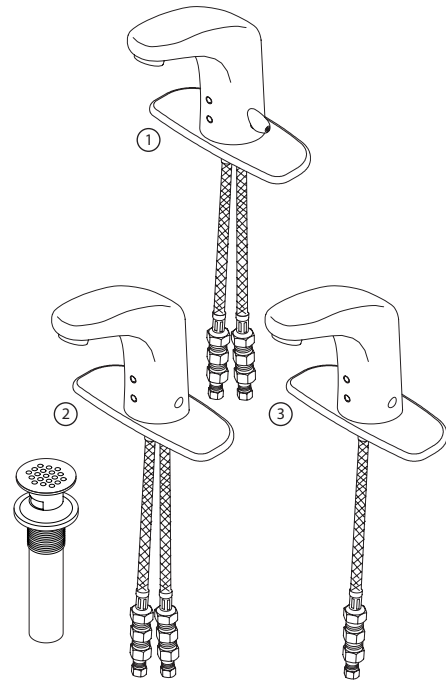

Modifications: **Suffix DP:** 8" adapter plate ▪ **Suffix OFG:** Offset grid strainer drain assembly in place of standard grid drain ▪ **Suffix NA:** Non-aerating laminar flow spray outlet (1.5gpm, 5.7 L/min) ▪ **Suffix SM:** Single hole mounting
Suffix LST: 18" long copper supply tubes

THE ULTRA-SENSE 5-YEAR GUARANTEE*

Every Symmons Ultra-Sense faucet is backed by the same legendary dedication to superior engineering that is found in all of our products. We're so confident in Ultra-Sense's reliability, we're willing to offer an unprecedented 5-year guarantee on its performance. It's just one more reason the Symmons Ultra-Sense faucet really makes sense.

*See your Symmons representative for complete details.

ULTRA-SENSE® Transformer-Powered Faucet

S-6110-G ULTRA-SENSE transformer-powered, sensor-activated lavatory faucet to meter a single tempered or cold water supply. Infrared reflective intensity detection system. 4" center deck plate. 1.5 gpm low profile, vandal-resistant aerator. 10-second factory set cycle time. In-line strainer. Grid strainer drain assembly.

Transformer must be specified separately.

S-6110 Faucet Only

ULTRA-SENSE Transformers

(for use with faucet model S-6110 only)

S-6200

ULTRA-SENSE plug-in transformer with 72" output cord and hold-down screw.

120 VAC/12 VDC, 60 Hz, 12 VA

S-6201

ULTRA-SENSE box-mounted transformer.

120 VAC/12 VAC, 60 Hz, 50 VA (will accommodate up to four (4) Ultra-Sense S-6110 series faucets)

S-6202

ULTRA-SENSE box-mounted transformer.

120 VAC/12 VAC, 60 Hz, 100 VA (will accommodate up to eight (8) Ultra-Sense S-6110 series faucets)



S-6110



Products meet ANSI A112.18.1M
Metering Faucets 0.25 gallons per cycle (1.0 L/cycle)



S-6300 ULTRA-SENSE Data Terminal

ULTRA-SENSE battery-powered, multi-function controller provides programming, data collection and diagnostic capabilities for all Ultra-Sense sensor operated faucets. Allows for easy troubleshooting and maintenance of extensive Ultra-Sense faucet installations.

Furnished complete with main power battery (9V DC), back up memory battery (CR20323V) and serial interface.

S-120-CK-NI THERMIXER®

THERMIXER thermostatic mixing valve with separate checks to deliver positive and accurate control of tempered water supply to a single or group of Ultra-Sense faucets. Flow rate of 15 gpm at 45 p.s.i. will supply up to 10 faucets at a standard flow rate of 1.5 gpm. Temperature range 85°F-120°F. Vandal-resistant lockable handle to prevent unauthorized tampering. Rough chrome finish. Note: Thermixer valves are available in sizes up to 1" I.P.S. (with and without cabinets). For details, refer to Symmons catalog Form No. ZT-TMX-1 or visit www.symmons.com.



Symmons®